

Reigate and Banstead Police Newsletter

Issue 4
August. 2023



Central Area Update Sergeant Rob Stapleton 4862

On Monday 21st August officers from the Reigate and Banstead Safer Neighbourhoods Team responded to reports of a burglary in Merstham. Thanks to their persistence at the scene, an offender was swiftly apprehended and arrested and was later found in possession of property linking him to other burglaries in East Surrey.

The offender was charged and remanded in police custody for 2 burglaries and bailed for others. He has been remanded into custody at court and awaits trial.

This is a fantastic result and a testament to our officers' hard work at the scene, supported by our colleagues from CID, which helped secure these charges. Burglaries remain a priority crime for the division and we will do everything we can to prosecute offenders.

Thank you

Crime statistics – May to July 2023

Offence	May-23	June-23	July-23
Residential Burglaries	19 (15)	31 (18)	20 (10)
Keyless Car Theft	6	5	4

(-) Actual residential burglaries only, not including -Attempted, Garage and Outbuilding Burglaries



Are you in the process of renovating a property that's currently not lived in?

Burglars often look to target homes with windows or doors left open, or with valuable features that they can exploit, particularly if they know a property is not currently lived in.

We are seeing an increase in properties like this being broken into and having tools stolen from traders who have left their tools in there overnight.

Detective Chief Inspector Gareth Hicks, East Surrey CID and Proactive Crime said: "My advice is to make sure you have CCTV, it can be set up quickly and wirelessly, for very little cost these days. You can also use motion activated security lighting to deter potential burglars. I'd also advise if you're in the process of renovating a property, please speak with traders and ask them not to leave their tools overnight."

Follow these tips:

- close and lock all windows and external doors when you leave the property
- double lock any doors
- make sure that any valuables are out of sight
- consider an alarm system that's clearly visible and outside lighting to deter opportunistic thieves
- make sure the side gate is locked
- get a trusted neighbour to keep an eye on your property or join a Neighbourhood or resident Watch Scheme
- register your property at <https://www.immobilise.com/> to improve the chances of getting your property back if it's stolen.
- mark your property with a forensic marking product such as <https://www.selectadna.co.uk/>



Keyless Car Thefts

We are seeing a reduction in the number of Keyless Car thefts in the Borough, which is good news.

However, we would still recommend that owners of Keyless cars are vigilant. Please remember we provide lots of advice on our website for keeping your car/van safe:

<https://www.surrey.police.uk/cp/crime-prevention/keeping-vehicles-safe/preventing-car-vehicle-theft/>

<https://www.surrey.police.uk/cp/crime-prevention/keeping-vehicles-sa>



Crime Prevention Advice

Door security



Whether you live in a flat or a house, your front door will always tell a thief the levels of security surrounding your home. If it looks really secure and burglar-resistant, then they'll think twice about trying to gain entry.

A locksmith belonging to the [Master Locksmiths Association](#) will check to see if your door is secure and made of solid timber or a robust composite. The locksmith can also reinforce the frame and check if the locks and hinges are British Standard approved.

Sliding patio doors are vulnerable to forced entry, so do check that yours have an anti-lift device fitted so they can't be lifted out of the frame.

Some uPVC doors are fitted with locks that protrude from the frame on the outside (euro profile locks for those in the know). If yours do, then consider getting a locksmith to change the lock to a shorter one that can't be snapped off.



1. If your door has a letterbox, a guard fitted to the rear of the door will prevent someone reaching in with a stick and a hook to fish for any nearby items such as a handbag or keys – which should never be kept near exterior doors. Consider cat flaps and dog flaps too.

2. Windows can be reinforced by using special film or by installing laminated panels.

3. Spy holes and security chains are recommended so that anyone visiting can be identified before you open the door.

4. Always remember to use both locks and check to make sure that the mortice lock is double-locked every time you leave your home.

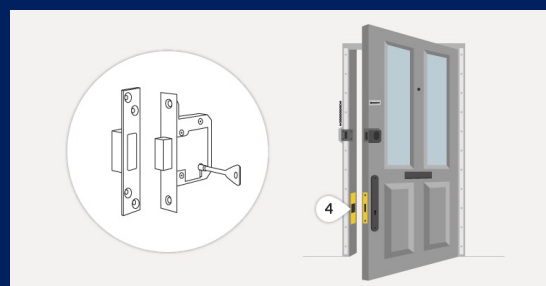

5. A simple turn of a double-locking night latch gives you added security and peace of mind.

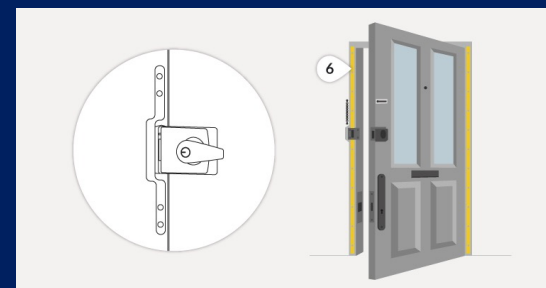
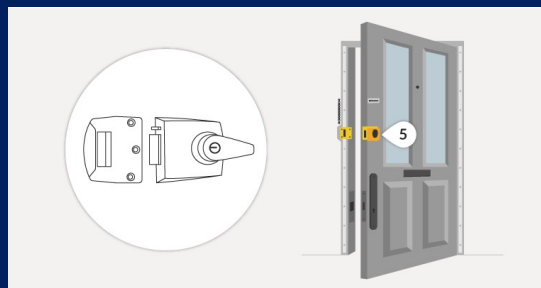

6. Door bars, such as a London Bar or Birmingham Bar greatly reinforce the doorframe and provide excellent protection against anyone trying to force a door open or kicking it down.

7. A lockguard does exactly that; it protects the keyhole and lock from being tampered with and is a great deterrent. If you are putting in a new door, always fit security accredited products as these are tested to British standards and approved by the insurance industry. Talk to your locksmith about standard PAS 24 2022.

If you are a building manager responsible for flats that are situated within larger buildings (for example, within apartment blocks), you should familiarise with up to date fire safety requirements prior to any changes to front doors.

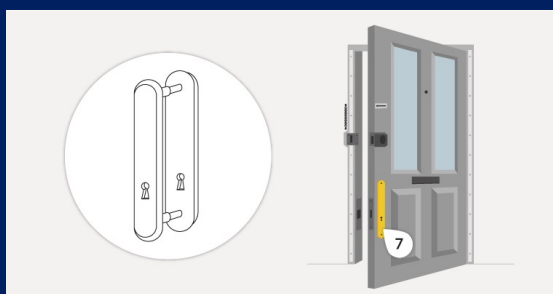



SPOTLIGHT

Surrey Police's HQ is going to remain in Guildford.



Mount Browne has been the headquarters of Surrey Police for over 70 years.

We know that parts of our estate are ageing; are not best designed to meet the needs of policing our communities in the 21st Century; and could be far more sustainable and efficient, both financially and environmentally. And we've been on a journey with Surrey residents as to how we serve you best in the years ahead.

The Force previously purchased land in Leatherhead, in 2018, to develop a new, purpose-built headquarters from the ground up.

However, following a review of the programme in November 2021, the Police and Crime Commissioner and the Surrey Police Chief Officer team took the decision to retain Mount Browne, and redevelop the existing site.

Since that decision, work has been taking place in the background as we reimagine the site, to ensure that Mount Browne and our wider estate is fit for the future over the long-term.

Surrey Police is hoping to put forward a planning application this Autumn and you can learn more about the plans using the link below

<https://www.surrey.police.uk/police-forces/surrey-police/areas/au/about-us/outfutureestate/>



People join Neighbourhood Watch for many different reasons, whether it is to improve safety around their home or to become part of a group and meet new people. It is widely

regarded that being part of Neighbourhood Watch can:

- Reduce / prevent local crime and disorder
- Reduce fear of crime
- Address issues relating to antisocial behaviour
- Create safer neighbourhoods
- Build community spirit and cohesion
- Reassure members of the public
- Enhance partnership working with other community groups
- Assist in the detection and apprehension of criminals through members providing information to the police
- Improve quality of life and the local environment

Whether you are thinking about joining, already a member or leading a scheme or an Association we have a range of crime prevention advice, and support materials to suit your needs

Find out more at:

<https://www.ourwatch.org.uk>

How to report a crime or incident:

Emergency: call 999

Non Emergency: call 101 or report online or via live chat at: www.surrey.police.uk

To contact your local team (not for reporting purposes) email: @surrey.pnn.police.uk

You can pass information to us directly via 101, online via <https://www.surrey.police.uk/ro/report/> or anonymously via Crimestoppers 0800555111, <https://crimestoppers-uk.org/>

Follow us:

Our Facebook is Reigate and Banstead Beat (Surrey Police) and our twitter is [@ReigateBeat](https://twitter.com/ReigateBeat).

